

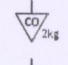

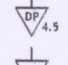
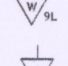
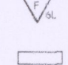
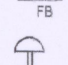
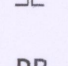

This drawing is the copyright of Axiom Architects.

It is for planning application purposes only & may not be reproduced in whole or in part without permission. Drawings lodged for planning approval may be reproduced by the Planning Authority in accordance with the 'Copyright (Material Open to Public Inspection) (Marking of Copies of Plans and Drawings) Order 1990 and must carry the relevant copyright restriction note.

- Internal licensed area to be licensed for all requested licensable activities.
- Licensable activities for the external area limited to sale by retail of alcohol, late night refreshment and recorded music only.

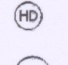
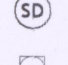
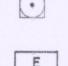
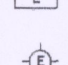
KEY TO SYMBOLS -

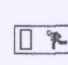
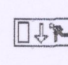
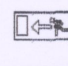
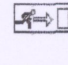
-  2kg carbon dioxide fire extinguisher
-  4.5kg dry powder extinguisher
-  9 litre water extinguisher
-  AFFF foam extinguisher
-  Fire blanket
-  Sounder
- PB** Panic bolt emergency door ironmongery with "push bar to open" notice
-  Vision panel to door of 6mm Georgian wired polished plate glass, or Pilkington "Pyran" fire resistant glass, set in intumescent putty with hardwood beads
-  Combined multi Detector & Sounder
-  Heat detector
-  Smoke detector
-  Break glass fire alarm call point
-  Three hour non-maintained emergency light fitting
-  Emergency Bulkhead light
- FIRE SIGNAGE:**
Illuminated 3 hour maintained emergency exit sign with legends to BS 5499 part 1 European directive
-  "Final Exit"
-  "Fire Exit This Way"
-  "Fire Exit, Left"
-  "Fire Exit, Right"
- FD30S** Fire door to half hour fire resistance with intumescent strips and cold smoke seal brushes. Frame/lining to have minimum 38 x 25mm stops (fixed at 300mm max centres with counter sunk screws if planted). Adjustable overhead door closer. "Fire door Keep Shut" notice both sides at eye level.

Surface spread of flame of walls and ceilings to be class "0". Class "3" items (curtains, drapes, timber, upholstery etc) to be upgraded to class "1" standard with proprietary treatment to a BBA certificate standard. Contractor to supply fire test certificate upon completion of treatment.
Note that the exact location of emergency lighting and detectors subject to fire officers report and electrical sub contractors design

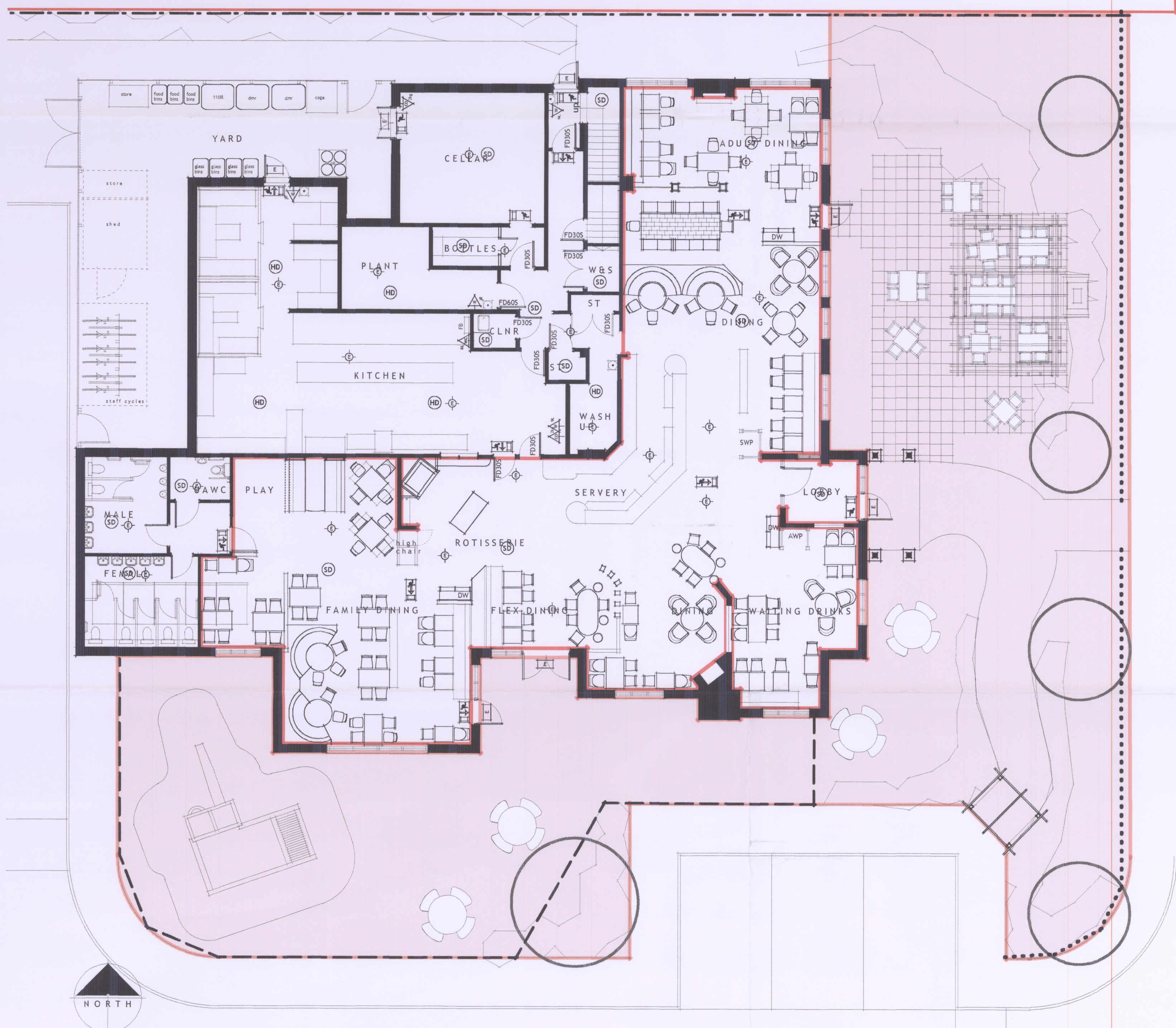

GROUND FLOOR PLAN

0 2 3 4 5 6 7 8 9 10 M

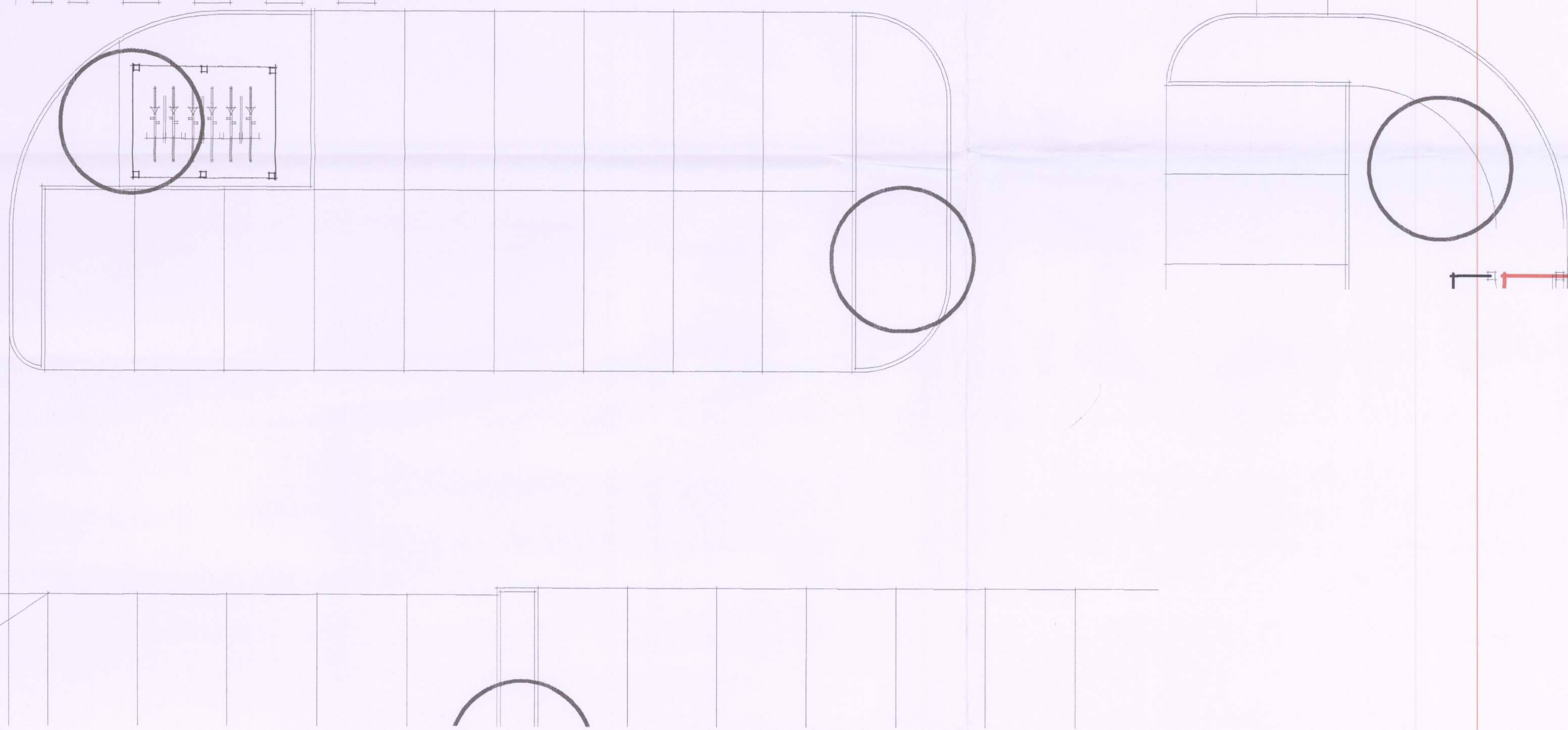

Rev	Date	Description	By

1 Brooklands Yard
Southover High Street
Lewes
East Sussex
BN7 1HU

Tel 01273 479269
Fax 01273 483060
www.axiomarchitects.co.uk

Client



Project
180 COVER FAMILY PUB RESTAURANT
NEWBURY COLLEGE
NEWBURY

Drawing
GROUND FLOOR LICENCE PLAN

Scale	Status	Date	Drawn	Checked
1:100@A1,200@A3	LICENCE	13.06.14	AJ	ACR

Drawing No. Revision

3336/L105